

# Tune VWD

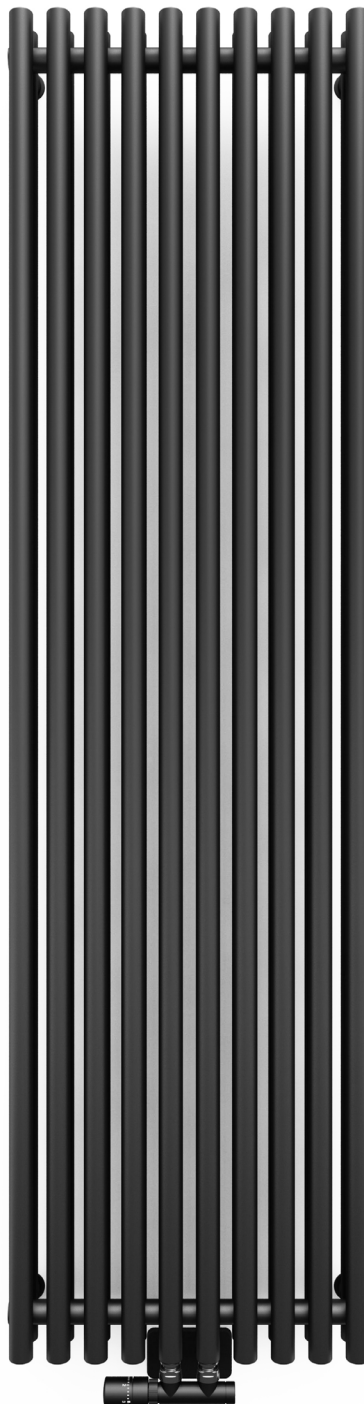

colour included  
in the price



**Tune VWD** 1800↓ × 490↔ ZX  
colour: Anodic Black

Integrated thermostatic valve, angled, right, black mat  
SLIM thermostatic head, black mat  
Integrated pipe-masking set, black mat





colour included  
in the price

Projekt : *Terma*

## Standard connection:

A ↓ 600÷1800:

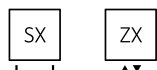

A ↓ 1800:

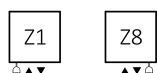

## Optional connection:

A ↓ 600÷1800:

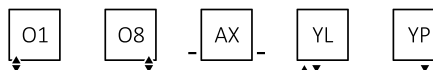

A ↓ 600:

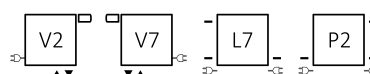
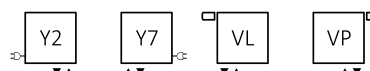

A ↓ 1800:

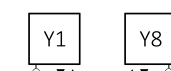

## Specification:

Working pressure: 1000 kPa    Maximum operating temperature: 95°C

A ↓ [mm]	B ↔ [mm]	C1 [mm]	C2 [mm]	C3 [mm]	75 65 20°C [W]	55 45 20°C [W]	☺ [W]	D [mm]	E [mm]	F [mm]	⊞ [dm³]	⚖ [kg]	Product code <small>Configuration code p. 7</small>
600	590	50	550	500	725	378	800	550	500	50	10,72	15,71	WGTUV060059
600	790	50	750	500	967	504	1000	750	500	50	14,30	20,92	WGTUV060079
600	990	50	950	500	1209	630	1200	950	500	50	17,87	26,13	WGTUV060099
600	1190	50	1150	500	1450	756	1500	1150	500	50	21,45	31,34	WGTUV060119
600	1390	50	1350	500	1693	883	1500	1350	500	50	25,03	36,55	WGTUV060139
600	1590	50	1550	500	1934	1008	—	1550	500	50	28,61	41,76	WGTUV060159
1800	290	50	250	1700	967	489	1000	250	1700	50	15,26	21,71	WGTUV180029
1800	490	50	450	1700	1612	815	1500	450	1700	50	25,44	36,06	WGTUV180049
1800	690	50	650	1700	2257	1141	—	650	1700	50	35,62	50,41	WGTUV180069

# Tune VWD



colour included  
in the price

## Available sizes:

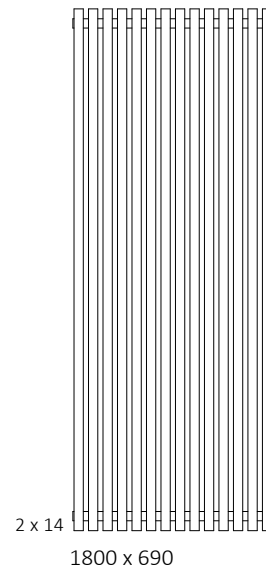
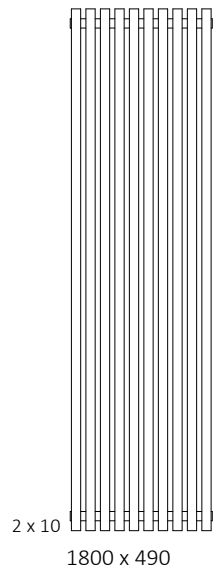
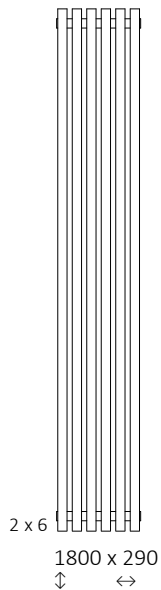
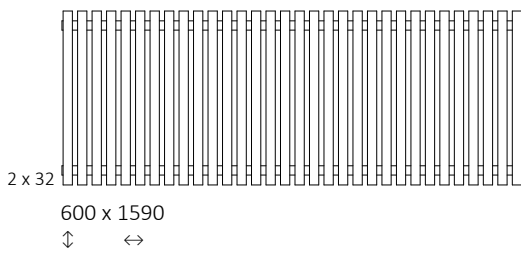
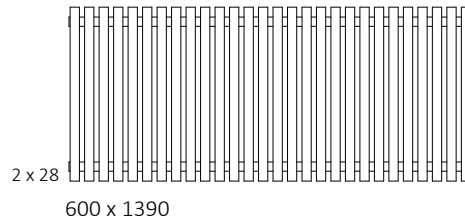
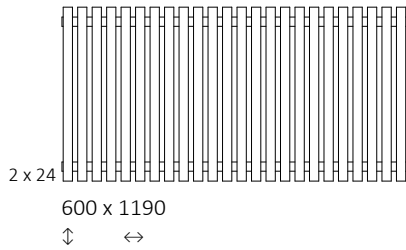
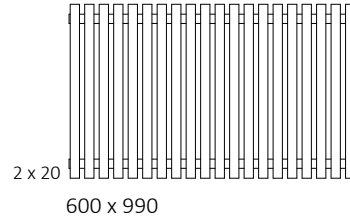
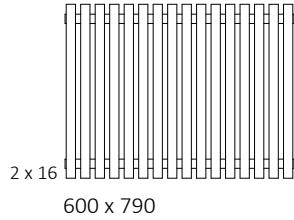
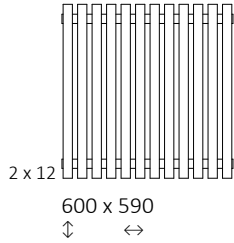



colour included  
in the price

## Technical drawing:

**SX**

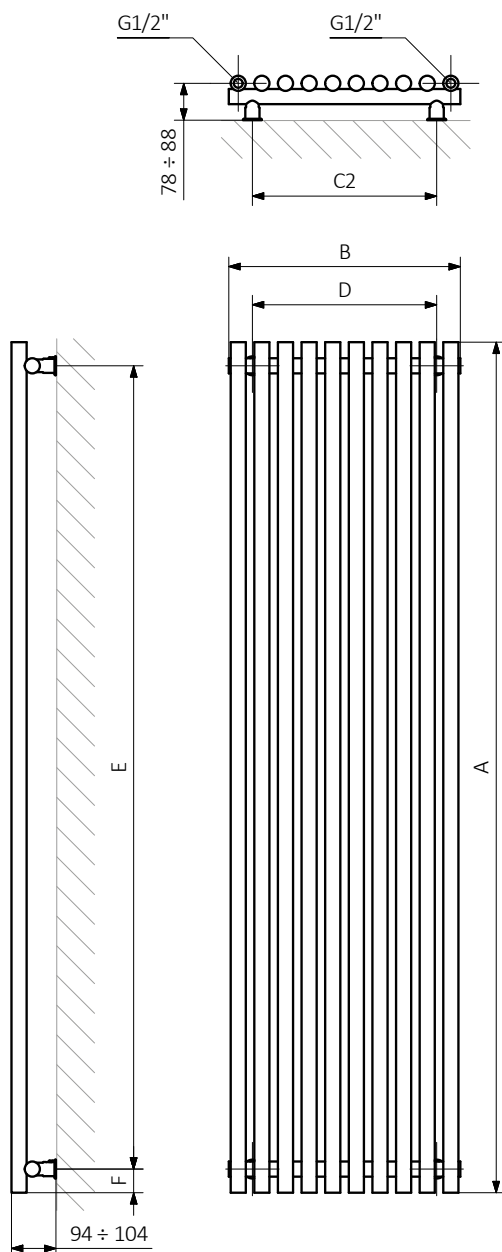

**ZX**

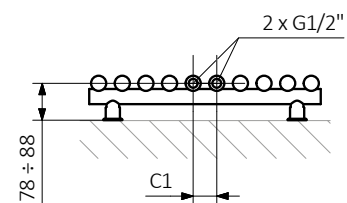

**Z1**

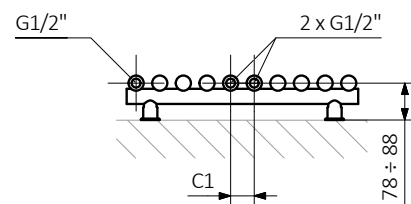

**Z8**

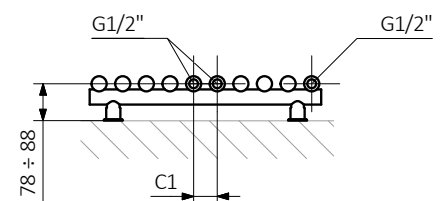

A – Height B – Width C1-C5 – Distance between pipe centres D – Horizontal distance between mounting bracket centres  
E – Vertical distance between mounting brackets F – Distance between a mounting bracket and the bottom of the radiator

**Pipes:**

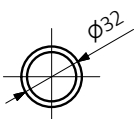



colour included  
in the price

## Technical drawing:

PX

LX

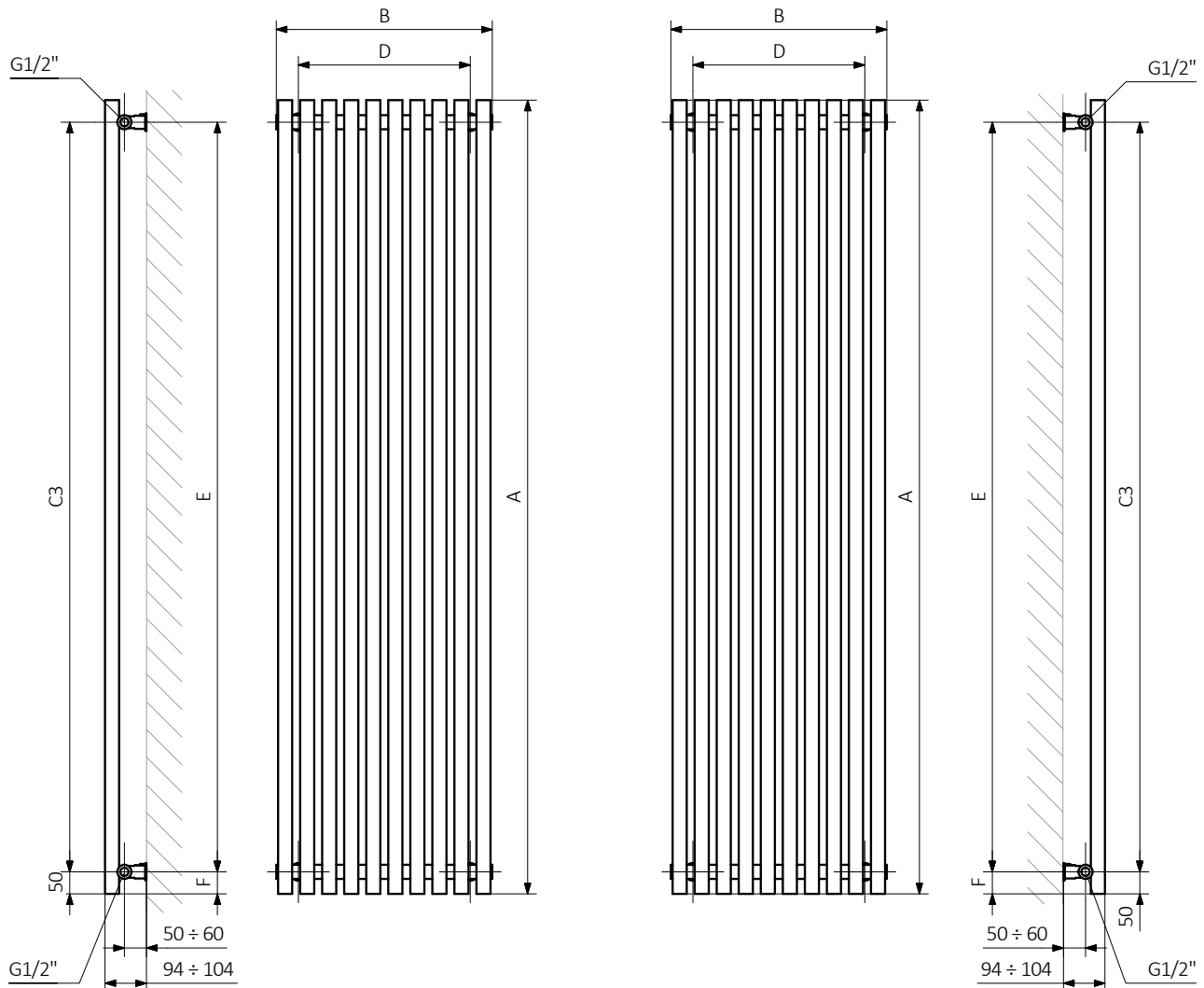

A – Height B – Width C1-C5 – Distance between pipe centres D – Horizontal distance between mounting bracket centres  
E – Vertical distance between mounting brackets F – Distance between a mounting bracket and the bottom of the radiator

Pipes:

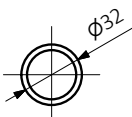

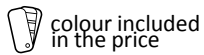

In the table with technical data, the last column lists product codes. When placing an order, please remember to quote the product code followed by the configuration code as shown in the diagram below:

## The construction of a water and dual fuel radiator product and configuration code:

WGTUV060059

PRODUCT CODE  
(located in the table for the product)

K916ZX

CONFIGURATION CODE  
(supplemented by hand)

### Example Configuration

**K** **916** **ZX**

Package code  
*K - carton box*

Colour code

Connection code

## Epoxy primer

**E** – Code of epoxy primer is an extra processes.

WGTUV060059 K916ZX **E** — *Extra processes or additions code*



colour included  
in the price

## Legend



Radiator available in a "water" version.



Radiator suitable for dual fuel connection. Electric heating element can be installed.



Radiator available in electric only version. It comes prefilled with a 'heating medium' and equipped with a heating element. All tested and ready to use.



Connection types dedicated for this radiator. The icon shows the flow and return connections for the radiator as well as the thermostatic valve and heating element position if applicable.



Suggested heating element power output for electric and dual fuel versions.



Weight.



Capacity.



Available in chrome finish.



colour  
included  
in the price

No additional payment for a color.