



RIGO
height 543 mm, length 1520 mm. Ivory finish (cod. 02).



Technical features:

- steel towel warmer
- 23 mm diameter horizontal round bar heating elements, projection welded on 30 mm manifold
- threading at the ends of the manifold, first lower pipe, right Gas 1/2"
- maximum working pressure 8 bar
- maximum working temperature 95°C

Price included:

- 4 CHELA connections for 30 mm diameter manifold
- 1/2" air vent

Special options and surcharges:

Radiators can be supplied with no. 1 1/2" coupling welded laterally for the connection to a single-pipe system and no. 2 1/2" couplings welded laterally to a manifold (Cod. B10).

Surcharge for two 1/2" couplings welded to a lateral manifold and an internal diaphragm (**Cod. B10**)

CAUTION: when this latter special working is present, correct operation is possible only when the lower outlet coupling is in axial alignment with the lowest pipe. Whenever this coupling is higher, all the pipes below will remain cold because they are not involved in the flow of water.

Prearrangement for monotube valve (**Cod. B14, B15**)

Finishes available	Surcharge
Standard White	
Classic finished	
Special finished	
Other RAL colors	

Finishing codes see page 596.

Connections

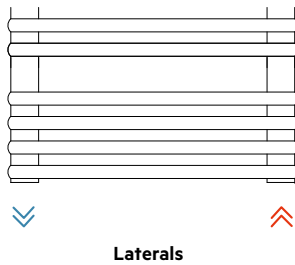

Connection dimensions with IRSAP valves

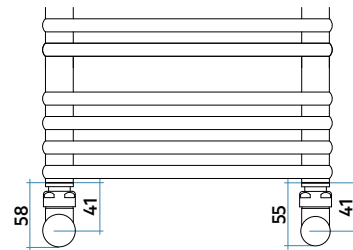

For other types of connections see pag. 414

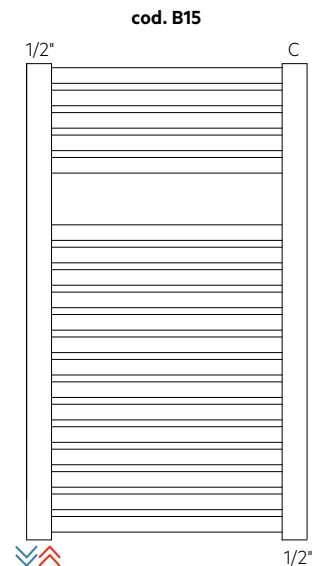
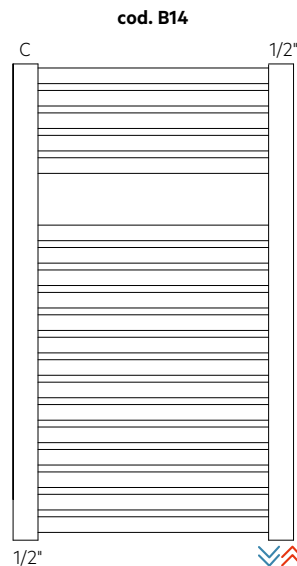
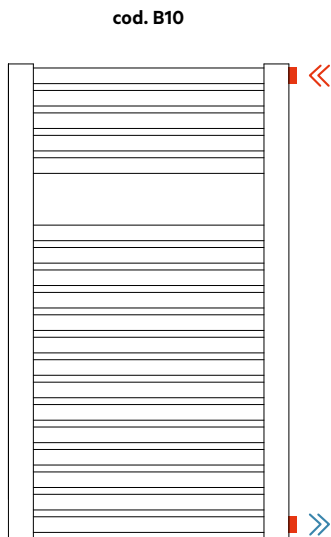

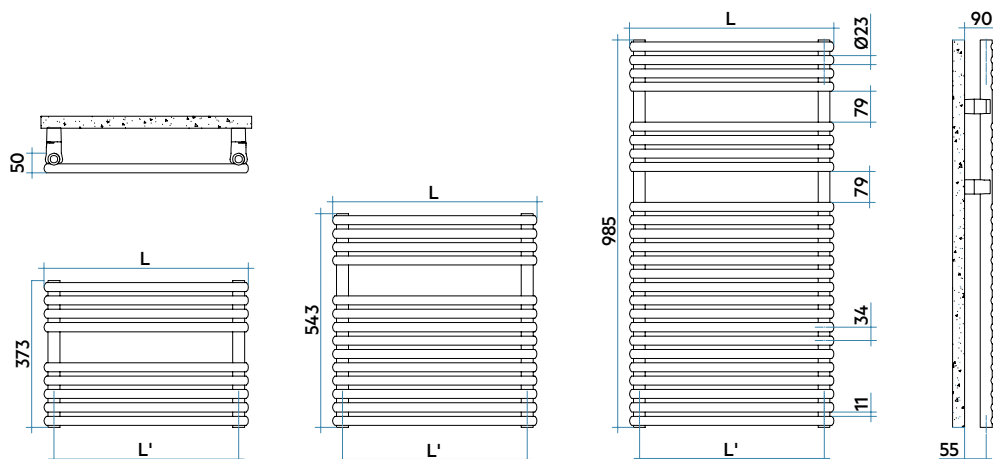

Model	Code	Depth mm	Height mm	Width mm	Conn. centre mm	Weight Kg	Cap. lt	Btu/h	Thermal Power				Exp. n.
									$\Delta t=50^{\circ}\text{C}$ Watt	$\Delta t=40^{\circ}\text{C}$ Watt	$\Delta t=30^{\circ}\text{C}$ Watt (*)	$\Delta t=20^{\circ}\text{C}$ Watt	
373 9 rails 1 espace	RIS052 B 01 IR 01 NNN	50	373	520	470	4,4	1,8	778	228	177	127	80	1,147
	RIS122 B 01 IR 01 NNN	50	373	1220	1170	8,6	3,9	1836	538	412	293	181	1,191
	RIS152 B 01 IR 01 NNN	50	373	1520	1470	10,4	4,8	2289	671	512	362	221	1,210
543 14 rails 1 espace	RIP052 B 01 IR 01 NNN	50	543	520	470	6,4	2,7	1095	321	249	179	112	1,146
	RIP122 B 01 IR 01 NNN	50	543	1220	1170	13,8	6,1	2736	802	615	437	270	1,190
	RIP152 B 01 IR 01 NNN	50	543	1520	1470	16,9	7,5	3439	1008	770	544	333	1,209
985 25 rails 2 espaces	RIM052 B 01 IR 01 NNN	50	985	520	470	11,2	5,0	2030	595	459	328	204	1,167
	RIM122 B 01 IR 01 NNN	50	985	1220	1170	23,8	9,8	4838	1418	1087	772	477	1,190
	RIM152 B 01 IR 01 NNN	50	985	1520	1470	29,2	11,8	6043	1771	1355	959	590	1,200

Mix. Funct.	Code
0	-
0	-
0	-
0	-
300	ANRES300WDI
400	ANRES400WDI
700	ANRES700WDI
1000	ANRES1000WDI
1000	ANRES1000WDI

Electric heater for Dual Power

BATHROOMS
RADIATORS

(*) Thanks to the high performance of Irsap RIGO radiators, the ideal Δt for low temperature projects is Δt at 30°C .

For Δt different from 50°C use the formula: $Q=Q_n (\Delta t / 50)^n$

To order a radiator in the mixed version put the code of the Standard version + the code of the corresponding electric heater

Example: Mod. 543 x 1220: **RIP122 B 01 IR 01 NNN** (€ 420,95) + **ANRES300WDI** (€ 167,75) = Tot. € 588,70

Key Codes

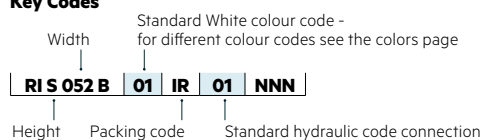

Decorative & Technical Accessories

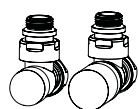

Kit Valves and Lockshield valve
Pag. 562

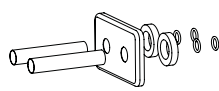

Pipe cover kit
Pag. 566

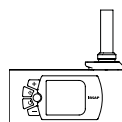

Electronic Control
Pag. 574

