

Pola

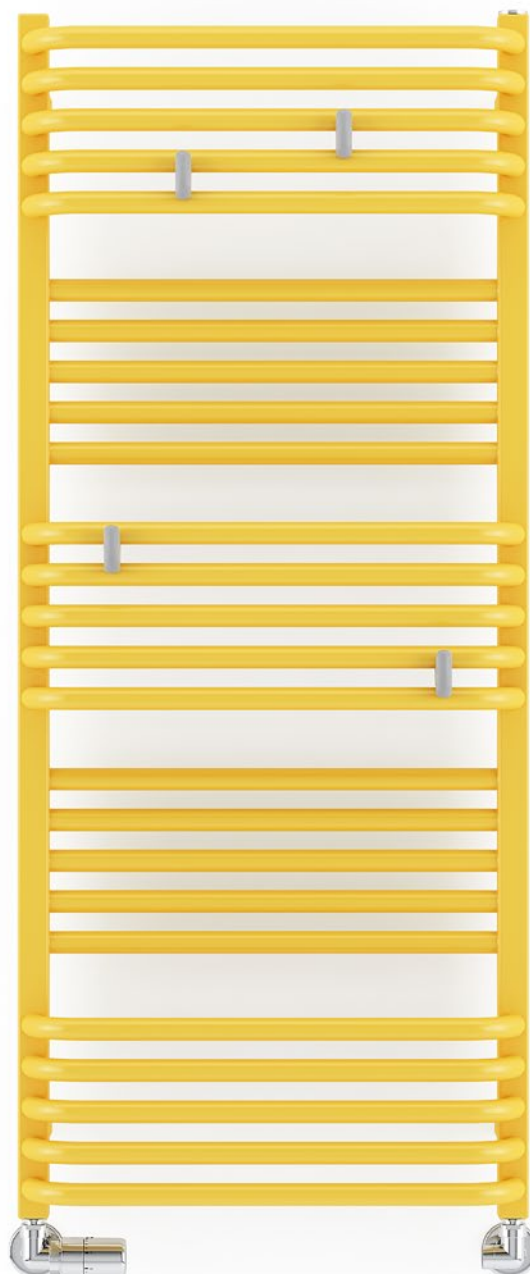

 colour included
in the price



Pola 1080↑ × 500↔ SX
colour: RAL 1023

3-axis thermostatic valve set, left, chrome
Pipe-masking set, chrome
Yo! hanger, grey



TERMA

SINCE 1990

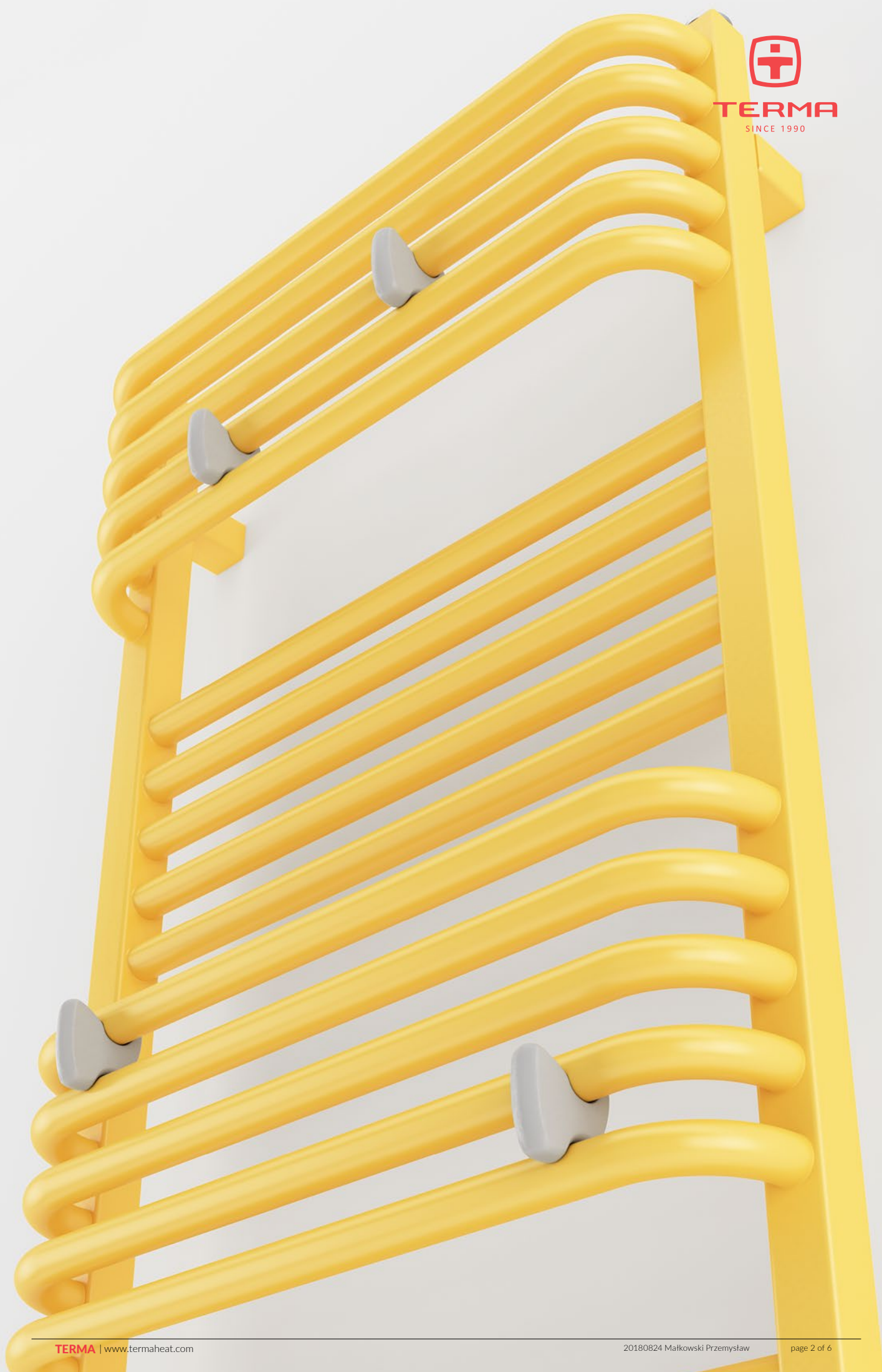



Design : Terma

Standard connection:

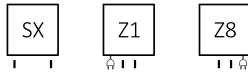

Electric radiators:

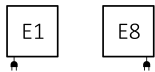

Optional connection:

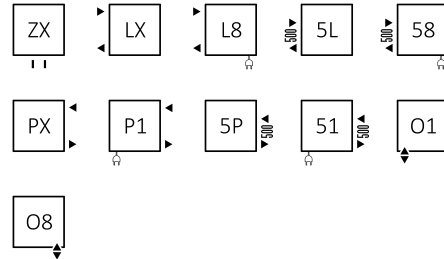

Available sizes:

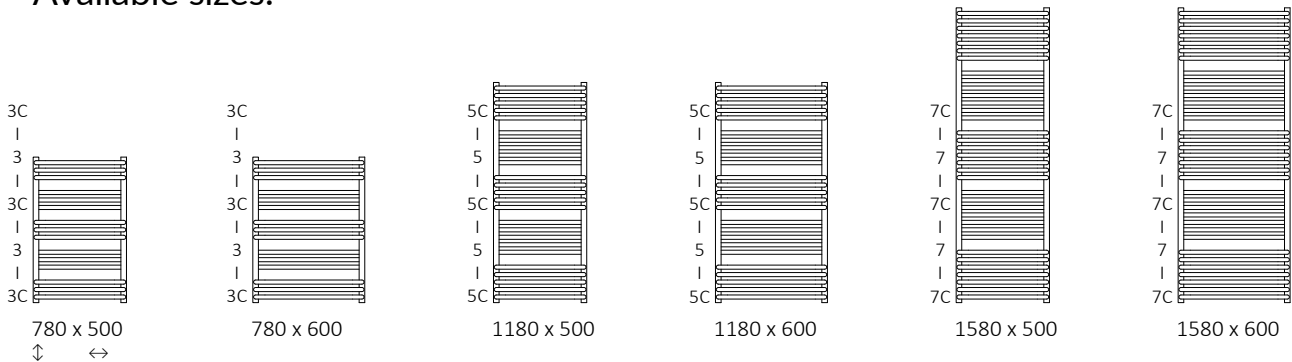

Specification:

Working pressure: 1000 kPa Maximum operating temperature: 95°C

A ↓ [mm]	B ↔ [mm]	C1 [mm]	C2 [mm]	75/65/20°C [W]	55/45/20°C [W]	☺ [W]	D [mm]	E [mm]	F [mm]	U [dm³]	W [kg]	Product code <small>Configuration code p. 5</small>
Paint												
780	500	50	470	392	211	400	470	600	90	3,34	6,99	WGPAL078050
780	600	50	570	471	254	400	570	600	90	3,79	7,99	WGPAL078060
1180	500	50	470	638	342	600	470	1000	90	5,39	11,28	WGPAL118050
1180	600	50	570	766	411	800	570	1000	90	6,14	12,95	WGPAL118060
1580	500	50	470	883	473	800	470	1400	90	7,44	15,57	WGPAL158050
1580	600	50	570	1061	568	1000	570	1400	90	8,49	17,91	WGPAL158060
Plating												
780	500	50	470	274	140	300	470	600	90	3,34	6,72	WGPAL078050
780	600	50	570	330	168	300	570	600	90	3,79	7,68	WGPAL078060
1180	500	50	470	447	228	400	470	1000	90	5,39	10,84	WGPAL118050
1180	600	50	570	536	273	600	570	1000	90	6,14	12,44	WGPAL118060
1580	500	50	470	618	315	600	470	1400	90	7,44	14,96	WGPAL158050
1580	600	50	570	743	379	800	570	1400	90	8,49	17,20	WGPAL158060

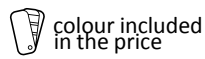

Technical drawing:

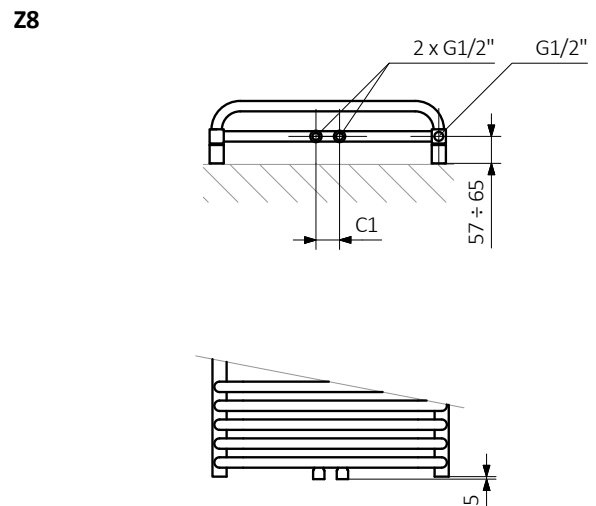
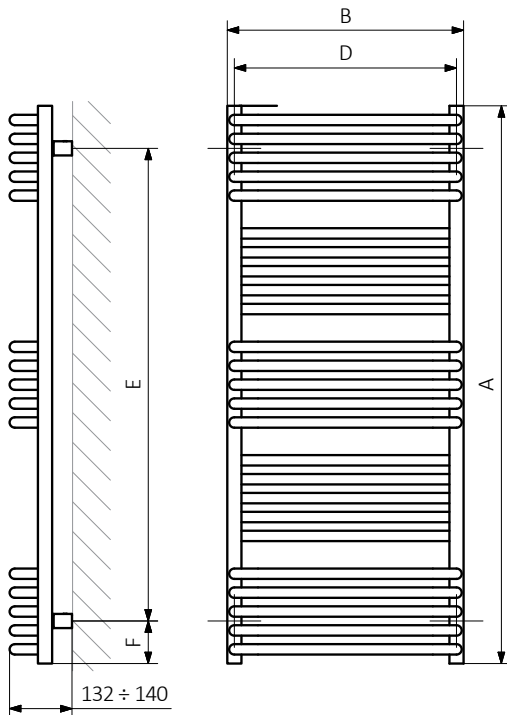
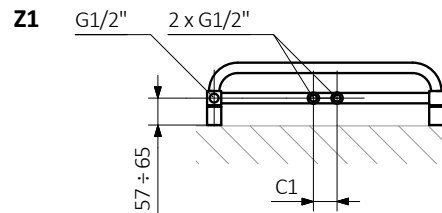
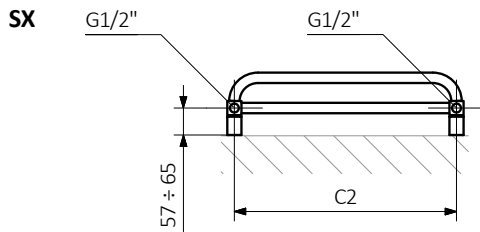

A – Height B – Width C1-C5 – Distance between pipe centres D – Horizontal distance between mounting bracket centres
E – Vertical distance between mounting brackets F – Distance between a mounting bracket and the bottom of the radiator

Collector : Pipe :

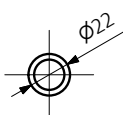
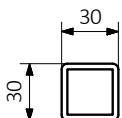

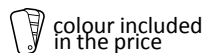

In the table with technical data, the last column lists product codes. When placing an order, please remember to quote the product code followed by the configuration code as shown in the diagram below:

The construction of a water and dual fuel radiator product and configuration code:

WG PAL078050

PRODUCT CODE
(located in the table for the product)

K916SX

CONFIGURATION CODE
(supplemented by hand)

Example Configuration

K 916 SX

Package code
K - carton box

Colour code

Connection code

Construction of electric heater configuration code:

WLPAL078050

PRODUCT CODE
(located in the table for the product)

K916E1DRYW

CONFIGURATION CODE
(supplemented by hand)

Example Configuration

K 916 E1 DRY W

Package code
K - carton box

Colour code

Connection code

Heating element code

Type of heating element cable code

Epoxy primer

E – Code of epoxy primer is an extra processes.

WG PAL078050 K916SX **E** — Extra processes or additions code

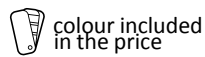
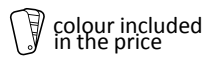

Legend



Radiator available in a "water" version.



Radiator suitable for dual fuel connection. Electric heating element can be installed.



Radiator available in electric only version. It comes prefilled with a 'heating medium' and equipped with a heating element. All tested and ready to use.



Connection types dedicated for this radiator. The icon shows the flow and return connections for the radiator as well as the thermostatic valve and heating element position if applicable.



Suggested heating element power output for electric and dual fuel versions.



Weight.



Capacity.



Available in chrome finish.



No additional payment for a color.